

## Wireless Stereo Headset

|                     |               |
|---------------------|---------------|
| <span></span>       | <span></span> |
| Reference Guide     | <b>GB</b>     |
| 參考指南                | <b>CT</b>     |
| 참고 설명서              | <b>KR</b>     |
| Справочник          | <b>RU</b>     |
| Довідковий посібник | <b>UA</b>     |



WI-C400

|               |               |
|---------------|---------------|
| <span></span> | <span></span> |
| <span></span> | <span></span> |
| <span></span> | <span></span> |
| <span></span> | <span></span> |

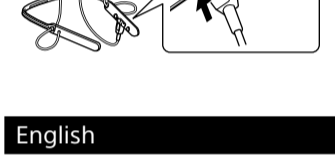
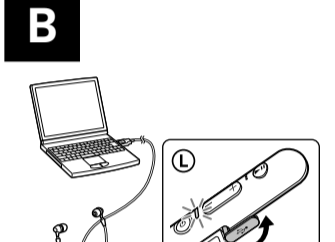
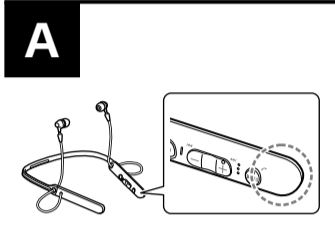

|               |               |
|---------------|---------------|
| <span></span> | <span></span> |
| <span></span> | <span></span> |
| <span></span> | <span></span> |
| <span></span> | <span></span> |

Do not install the appliance in a confined space, such as a bookcase or built-in cabinet.

Do not expose the batteries (battery pack or batteries installed) to excessive heat such as sunshine, fire or the like for a long time.

Do not dismantle, open or shred secondary cells or batteries.

In the event of a cell leaking, do not allow the liquid to come in contact with the skin or eyes. If contact has been made, wash the affected area with copious amounts of water and seek medical advice.

Secondary cells and batteries need to be charged before use. Always refer to the manufacturer’s instructions or equipment manual for proper charging instructions. After extended periods of storage, it may be necessary to charge and discharge the cells or batteries several times to obtain maximum performance. Dispose of properly.

|                                      |               |
|--------------------------------------|---------------|
| <span></span>                        | <span></span> |
| Complies with IMDA Standards DB00353 | <span></span> |
| <span></span>                        | <span></span> |
| <span></span>                        | <span></span> |

|                           |
|---------------------------|
| <b>TRA</b>                |
| REGISTERED No: ER55049/17 |
| DEALER No: DA0096946/12   |
| <span></span>             |

The validity of the CE marking is restricted to only those countries where it is legally enforced, mainly in the countries EEA (European Economic Area).

The Bluetooth® word mark and logos are registered trademarks owned by the Bluetooth SIG, Inc. and any use of such marks by Sony Corporation is under license.

The N-Mark is a trademark or registered trademark of NFC Forum, Inc. in the United States and in other countries.

Windows is a registered trademark or trademark of Microsoft Corporation in the United States and/or other countries.

Mac, OS X and iPhone are trademarks of Apple Inc., registered in the U.S. and other countries.

Android is a trademark of Google Inc.

Other trademarks and trade names are those of their respective owners.

## Precautions

**On BLUETOOTH communications**

- BLUETOOTH wireless technology operates within a range of about 10 m. Maximum communication range may vary depending on obstacles (human body, metal, wall, etc.) or electromagnetic environment.
- The antenna is built into the unit as illustrated in the dotted line (Fig. **A**). The sensitivity of the BLUETOOTH communications will improve by turning the direction of the built-in antenna to the connected BLUETOOTH device. When obstacles are between the antenna of the connected device and the built-in antenna of this unit, noise or audio dropout may occur, or communications may be disabled.
- BLUETOOTH communications may be disabled, or noise or audio dropout may occur under the following conditions.
  - There is a human body between the unit and the BLUETOOTH device.
  - There is an obstacle, such as metal or wall, between the unit and the BLUETOOTH device.
  - A device using 2.4 GHz frequency, such as a Wi-Fi device, cordless telephone, or microwave oven, is in use near this unit.
- Because BLUETOOTH devices and Wi-Fi (IEEE802.11b/g/n) use the same frequency (2.4 GHz), microwave interference may occur resulting in noise or audio dropout or communications being disabled if this unit is used near a Wi-Fi device. In such a case, perform the following.
  - Use this unit at least 10 m away from the Wi-Fi device.
  - If this unit is used within 10 m of a Wi-Fi device, turn off the Wi-Fi device.
  - Install this unit and the BLUETOOTH device as near to each other as possible.
- Microwaves emitting from a BLUETOOTH device may affect the operation of electronic medical devices. Turn off this unit and other BLUETOOTH devices in the following locations, as it may cause an accident.
  - where inflammable gas is present, in a hospital, or a petrol station
  - near automatic doors or a fire alarm.
- Do not use the unit on an airplane. Radio waves may affect instruments, causing an accident due to malfunction.
- Due to the characteristic of the wireless technology, the sound played on this unit is delayed from the sound and music played on the sending device. Therefore, the image and sound may be misaligned when viewing a movie or playing a game.
- This unit supports security capabilities that comply with the BLUETOOTH standard to provide a secure connection when the BLUETOOTH wireless technology is used, but security may not be enough depending on the setting. Be careful when communicating using BLUETOOTH wireless technology.

©2017 Sony Corporation
Printed in Vietnam

4-698-106-33(1)

|                     |               |
|---------------------|---------------|
| <span></span>       | <span></span> |
| Reference Guide     | <b>GB</b>     |
| 參考指南                | <b>CT</b>     |
| 참고 설명서              | <b>KR</b>     |
| Справочник          | <b>RU</b>     |
| Довідковий посібник | <b>UA</b>     |



|               |               |
|---------------|---------------|
| <span></span> | <span></span> |
| <span></span> | <span></span> |
| <span></span> | <span></span> |
| <span></span> | <span></span> |

- We do not take any responsibility for the leakage of information during BLUETOOTH communications.
- Connection with all BLUETOOTH devices cannot be guaranteed.
  - A device featuring BLUETOOTH function is required to conform to the BLUETOOTH standard specified by Bluetooth SIG, Inc. and be authenticated.
  - Even if the connected device conforms to the above mentioned BLUETOOTH standard, some devices may not be connected or work correctly, depending on the features or specifications of the device.
- While talking on the phone hands free, noise may occur, depending on the device or communication environment.
- Depending on the device to be connected, it may require some time to start communications.

**If sound skips frequently during playback**

- The situation may be improved by changing the wireless playback quality settings or fixing the wireless playback mode to SBC on the transmitting device. For details, refer to the operating instructions supplied with the transmitting device.
- If you are using a smartphone, the situation may be improved by shutting down unnecessary applications or rebooting the smartphone.

**On the use of calling apps for smartphones and computers**

- This unit supports normal incoming calls only. Calling apps for smartphones and computers are not supported.

**On charging the unit**

- This unit can be charged using USB only. Personal computer with USB port is required for charging.
- This unit cannot be turned on, nor can the BLUETOOTH function be used, during charging.
- If you do not use the unit for a long time, the rechargeable battery may not be able to keep sufficient charge. The battery will be able to keep a charge properly after repeatedly discharging and charging several times.
- If you store the unit for a long time, charge the battery once every half year to prevent over-discharge.
- After the length of time you can use the unit became extremely short, the rechargeable battery should be replaced with a new one. Please contact your nearest Sony dealer for a battery replacement.

**Note on static electricity**

- Static electricity accumulated in the body may cause mild tingling in your ears. To minimise the effect, wear clothes made from natural materials.

**If the unit does not operate properly**

- Reset the unit (Fig. **B**). When resetting this unit, charge the unit. When charging starts, this unit is reset automatically. The pairing information and the other settings are retained.
- If the problem persists even after the resetting operation above, initialize the unit as follows. Disconnect the micro-USB cable from the micro-USB port, turn off the unit, then hold down the **○** and **▶** buttons simultaneously for more than 7 seconds. The indicator (blue) flashes 4 times, and the unit is reset to the factory settings. All pairing information is deleted.
- After the unit is initialized, it may not connect to your iPhone or computer. In this case, delete the pairing information of the unit from the iPhone or computer, and then pair them again.

**Others**

- Do not place this unit in a place exposed to humidity, dust, soot or steam, or subject to direct sunlight. Do not leave the unit in a car for a long time. It may cause a malfunction.
- Using the BLUETOOTH device may not function on mobile phones, depending on radio wave conditions and location where the equipment is being used.
- High volume may affect your hearing.
- For traffic safety, do not use while driving or cycling.
- Do not use the unit in places where it would be dangerous if you are unable to hear ambient sound, such as at railroad crossings, train station platforms, and construction sites.
- Do not put weight or pressure on this unit as it may cause the unit to deform during long storage.
- Do not subject the unit to excessive shock.
- Clean the unit with a soft dry cloth.
- Do not expose the unit to water. The unit is not waterproof. Remember to follow the precautions below.
  - Be careful not to drop the unit into a sink or other container filled with water.
  - Do not use the unit in humid locations or bad weather, such as in the rain or snow.
  - Do not get the unit wet.
  - If you touch the unit with wet hands, or put the unit in a damp article of clothing, the unit may get wet and this may cause a malfunction of the unit.
- If you experience discomfort after using the unit, stop using the unit immediately.
- Install the earbuds firmly. If an earbud accidentally detaches and is left in your ear, it may cause injury.
- Since children may swallow small parts such as an earbud, keep the unit out of reach of children.
- If you have any questions or problems concerning this unit that are not covered in this manual, please consult your nearest Sony dealer.

|                                                                            |               |
|----------------------------------------------------------------------------|---------------|
| <span></span>                                                              | <span></span> |
| Optional replacement earbuds can be ordered from your nearest Sony dealer. | <span></span> |
| <span></span>                                                              | <span></span> |
| <span></span>                                                              | <span></span> |

## Specifications

|                                                                                                                                                                                                                                                                                                                                   |
|-----------------------------------------------------------------------------------------------------------------------------------------------------------------------------------------------------------------------------------------------------------------------------------------------------------------------------------|
| <b>General</b>                                                                                                                                                                                                                                                                                                                    |
| <b>Communication system:</b> BLUETOOTH Specification version 4.2                                                                                                                                                                                                                                                                  |
| <b>Output:</b> BLUETOOTH Specification Power Class 2                                                                                                                                                                                                                                                                              |
| <b>Maximum communication range:</b> Line of sight approx. 10 m <sup>1)</sup>                                                                                                                                                                                                                                                      |
| <b>Frequency band:</b> 2.4 GHz band (2,400GHz)                                                                                                                                                                                                                                                                                    |
| <b>Compatible BLUETOOTH profiles:</b> <sup>2)</sup> <ul style="list-style-type: none"><li>A2DP (Advanced Audio Distribution Profile)</li> <li>AVRCP (Audio Video Remote Control Profile)</li> <li>HFP (Hands-free Profile)</li> <li>HSP (Headset Profile)</li> <li>Codec:<sup>3)</sup> SBC<sup>®</sup>, AAC<sup>®</sup></li></ul> |
| <b>Supported content protection method:</b> SCMS-T                                                                                                                                                                                                                                                                                |
| <b>Transmission range (A2DP):</b> <ul style="list-style-type: none"><li>20 Hz - 20,000 Hz (Sampling frequency 44.1 kHz)</li></ul>                                                                                                                                                                                                 |

**Included items:**

- Wireless stereo headset (1)
- Micro-USB cable (approx. 50 cm) (1)
- Hybrid silicone rubber earbuds (SS/S/M/L 2 each)
- Reference Guide (this sheet) (1)
- Operating Instructions (1)
- Other documents (1 set)

- The actual range will vary depending on factors such as obstacles between devices, magnetic fields around a microwave oven, static electricity, reception sensitivity, antenna’s performance, operating system, software application, etc.
- BLUETOOTH standard profiles indicate the purpose of BLUETOOTH communications between devices.
- Codec: Audio signal compression and conversion format
- Subband Codec
- Advanced Audio Coding

|                                                                                                                                                                                                                                                                                                                                                                              |
|------------------------------------------------------------------------------------------------------------------------------------------------------------------------------------------------------------------------------------------------------------------------------------------------------------------------------------------------------------------------------|
| <b>Wireless stereo headset</b>                                                                                                                                                                                                                                                                                                                                               |
| <b>Power source:</b> <ul style="list-style-type: none"><li>DC 3.7 V: Built-in lithium-ion rechargeable battery</li> <li>DC 5 V: When charged using USB</li></ul>                                                                                                                                                                                                             |
| <b>Mass:</b> Approx. 35 g                                                                                                                                                                                                                                                                                                                                                    |
| <b>Operating temperature:</b> 0 <span> </span> °C to 40 <span> </span> °C                                                                                                                                                                                                                                                                                                    |
| <b>Rated power consumption:</b> 0.63 W                                                                                                                                                                                                                                                                                                                                       |
| <b>Usage hours:</b> <ul style="list-style-type: none"><li>When connecting via the BLUETOOTH device <ul style="list-style-type: none"><li>Music playback time: Max. 20 hours</li> <li>Communication time: Max. 20 hours</li> <li>Standby time: Max. 200 hours</li></ul></li> <li>Note: Usage hours may be shorter depending on the Codec and the conditions of use.</li></ul> |
| <b>Charging time:</b> <ul style="list-style-type: none"><li>Approx. 4.5 hours (About 60 minutes of music playback is possible after 15 minutes charging.)</li> <li>Note: Charging hours may be different depending on the conditions of use.</li></ul>                                                                                                                       |
| <b>Charging temperature:</b> 5 <span> </span> °C to 35 <span> </span> °C                                                                                                                                                                                                                                                                                                     |

|                                             |
|---------------------------------------------|
| <b>Receiver</b>                             |
| <b>Type:</b> Closed, Dynamic                |
| <b>Driver unit:</b> 9 mm                    |
| <b>Frequency response:</b> 8 Hz - 22,000 Hz |

|                                                    |
|----------------------------------------------------|
| <b>Microphone</b>                                  |
| <b>Type:</b> Electret condenser                    |
| <b>Directivity:</b> Omni directional               |
| <b>Effective frequency range:</b> 50 Hz - 8,000 Hz |

### System requirements for battery charge using USB

(As of August 2017)

Personal computer with pre-installed with any of the following operating systems and USB port:

**Operating Systems** (when using Windows)
Windows® 10 Home / Windows® 10 Pro
Windows® 8.1 / Windows® 8.1 Pro
Windows® 8 / Windows® 8 Pro
Windows® 7
Home Basic / Home Premium / Professional / Ultimate

(when using Mac)
Mac OS X (version 10.9 or later)

Design and specifications are subject to change without notice.

### 繁體中文

請勿將本系統安放在書櫃或壁櫥等狹窄封閉處。

請勿將電池（安裝的電池組或電池）長時間暴露在如陽光或火源等類似過熱的地方。

經型式認證合格之低功率射頻電機，非經許可，公司、商號或使用均不得擅自變更頻率、加大功率或變更原設計之特性及功能。

低功率射頻電機之使用不得影響飛航安全及干擾合法通信；經發現有干擾現象時，應立即停用，並改善至無干擾時方得繼續使用。前項合法通信，指依電信法規定作業之無線電通信。低功率射頻電機禁止對合法通信或工業、科學及醫療用電波輻射性電機設備之干擾。

## 僅適用於台灣

## 廢電池請回收

CE 標記的效力，僅限於那些對該標記有法律強制性規定的國家， 主要为EEA（歐洲經濟區）國家。

Bluetooth®字樣與商標為Bluetooth SIG, Inc. 所擁有的註冊商標。 Sony Corporation針對此類標示的使用已獲得授權。

N字標示為NFC Forum, Inc. 在美國和其他國家的商標或註冊商標。

Windows是Microsoft Corporation在美國和/或其他國家的註冊商標或商標。

Mac, OS X和iPhone是Apple Inc. 在美國和其他國家註冊的商標。

Android為Google Inc.的商標。

其他商標和商標名稱為其各自所有人擁有。

## 預防措施

**關於BLUETOOTH通訊**

- BLUETOOTH無線技術可在約10 m的範圍內運作。最大通訊範圍可能依障礙物（人體、金屬、牆面等）或電磁環境不同而定。
- 天線內建在裝置中，如圖中虛線所示（圖**A**）。將內建天線朝連接的BLUETOOTH裝置方向轉動可以增加BLUETOOTH通訊的敏感度。若連接裝置的天線與本機內建天線之間有障礙物，可能會出現雜訊或音訊中斷的情況，也可能無法使用通訊功能。
- 在以下情況中，BLUETOOTH通訊可能無法使用，或者會出現雜訊或音訊中斷的情況。
  - 本機與BLUETOOTH裝置之間有人體阻隔。
  - 將BLUETOOTH裝置面對本機天線放置位置可改善此情況。
  - 本機和BLUETOOTH裝置間有金屬或牆面等障礙物。
  - Wi-Fi裝置、無線電話、或微波爐等 2.4 GHz頻率的裝置正在本機附近使用。
  - 由於BLUETOOTH裝置和Wi-Fi（IEEE802.11b/g/n）使用相同頻率（2.4 GHz），若本機在Wi-Fi裝置附近使用，可能會發生微波干擾等導致雜訊、音訊中斷或是通訊功能無法使用等情況。在此情況下，請執行以下步驟。
    - 請在距離Wi-Fi裝置至少10 m的地方使用本機。
    - 若要在距離Wi-Fi裝置10 m內的地方使用本機，請關閉Wi-Fi裝置。
    - 將本機和BLUETOOTH裝置安裝在盡量靠近此的地方。
  - 從BLUETOOTH裝置放射出的微波可能會影響電子醫療裝置的操作。在以下地點請關閉本機和其他BLUETOOTH裝置，以免造成意外：
    - 有易燃性瓦斯的地點、醫院或加油站
    - 靠近自動門或火警警鈴的地方。
  - 請勿在飛機上使用本機。無線電波可能影響儀器，並造成故障等導致意外。
  - 由於無線技術的特性，本機上播放的聲音彼此發送裝置上播放的聲音和音樂。因此，觀看電影或玩遊戲時，影像和聲音可能不同步。
  - 本機支援符合BLUETOOTH標準的安全性，以便在使用BLUETOOTH無線技術時提供安全的連接，但依設定不同而定。安全性可能會不足。使用BLUETOOTH無線技術進行通訊時，請務必小心。
  - 對於BLUETOOTH通訊期間的資訊外洩，本公司不負任何責任。
  - 不建議與所有BLUETOOTH裝置均能連接。
    - 有BLUETOOTH功能的裝置必須符合 Bluetooth SIG, Inc. 指定的BLUETOOTH標準並取得認證。
    - 即使連接的裝置符合上述BLUETOOTH標準，依裝置功能或規格不同而定，部分裝置仍可能無法正確連接或運作。
    - 使用手機的免持聽筒通話時，依裝置或通訊環境不同而定，可能會產生雜訊。
    - 依要連接的裝置不同而定，可能需要一些時間才能開始通話。
- 如果播放時經常跳音**
  - 在傳輸裝置上變更無線播放品質設定或是將無線播放模式固定為SBC，可以改善此情況。詳細資訊，請參閱傳輸裝置提供的使用說明書。
  - 如果正在使用智慧型手機，或許可以透過關閉不需要的應用程式或重新啟動智慧型手機來改善狀況。

**關於使用智慧型手機和電腦的通話應用程式**

- 本機僅支援一般來電，不支援智慧型手機和電腦的通話應用程式。

**關於為本機充電**

- 僅可使用USB為本機充電。需要帶有USB連接埠的個人電腦才能充電。
- 充電期間內本機無法開機，也無法使用BLUETOOTH功能。
- 若長時間未使用本機，充電電池可能無法維持足夠電量。電池要重複充電及充電數次後，才能適當地維持電量。
- 若您要長時間存放本機，請每半年讓電池充電一次，避免過度放電。
- 若本機可供使用時間顯著非常短，就應該更換新的充電電池。請聯絡附近的Sony經銷商更換電池。

**靜電注意事項**

- 體內積聚的靜電可能會導致耳朵有輕微刺痛感。穿著天然材料製成的衣服可將此影響減到最少。

**本機無法正常運作時**

- 請重設本機（圖**B**）。若嚴重設本裝置，請對本裝置充電。充電開始時，本裝置將自動重設。配對資訊和其他設定將保留。
- 若經過以上重設操作後問題仍然存在，請按下列步驟初始化本機。
  - 關閉micro-USB連接線與micro-USB連接埠的連接，關閉本機，然後同時按住**○**和**▶**按鈕超過7秒。指示燈（藍色）將閃爍四次，此時本機將重回到廠設定。所有配對資訊皆被刪除。

本機初始化後，可能無法連線至iPhone或電腦。在這種情況下，請由iPhone或電腦刪除本機配對資訊，然後再次配對。

**其他**

- 請勿將本機放置在暴露於濕氣、灰塵、油煙或蒸汽、或是受陽光直射的地方。請勿長時間將本機留在車內。這樣可能會引起故障。
- 依無線電波情況和裝備正在使用的地點不同而定，BLUETOOTH裝置可能無法在手機上作用。
- 音音量可能會影響您的聽力。
- 為了交通安全，切勿在駕車或騎車時使用耳機。
- 在無法聽到周圍聲音會造成危險的環境，如鐵路平交道、火車站月台、工地等，請勿使用耳機。
- 請勿將重物放置在本機上或施加強力，因為長時間存放時可能造成本機變形。
- 請勿讓本機受到嚴重撞擊。
- 請勿用柔軟的乾布清潔本機。
- 請勿將本機放在水中，本機不防水。務必遵守以下注意事項：
  - 請小心不要讓本機跌落洗衣槽或其他裝滿水的容器裡。
  - 切勿在潮濕的場所或在天氣不良的情況下使用本機，例如：下雨或下雪。
  - 切勿弄濕本機。
  - 如果用潮濕的手觸碰本機，或將本機放在潮濕的衣物內，則可能會弄濕本機，並可能造成本機故障。
  - 若您在使用本機後感到不適，請立即停止使用本機。
  - 將耳塞安裝牢固。如果耳塞不小心脫落在您耳朵內，可能會造成傷害。
  - 由於兒童可能會吞下耳塞等小零件，請使本機遠離兒童。
  - 若您有任何關於本機的疑問或問題未在本說明書中涉及，請聯絡附近的Sony經銷商。

|                         |               |
|-------------------------|---------------|
| <span></span>           | <span></span> |
| 可向附近的Sony經銷商訂購選購的替換用耳塞。 | <span></span> |
| <span></span>           | <span></span> |
| <span></span>           | <span></span> |

## 規格

|                                               |
|-----------------------------------------------|
| <b>一般資訊</b>                                   |
| <b>通訊系統:</b> BLUETOOTH規格版本4.2                 |
| <b>輸出:</b> BLUETOOTH規格Power Class 2           |
| <b>最大通訊範圍:</b> 直視距離約10 m <sup>1)</sup>        |
| <b>頻段:</b> 2.4 GHz波段 (2,400 GHz - 2,4835 GHz) |

|                                                                                                                                                                                                |
|------------------------------------------------------------------------------------------------------------------------------------------------------------------------------------------------|
| <b>相容的BLUETOOTH模式</b> <sup>2)</sup> :                                                                                                                                                          |
| A2DP (Advanced Audio Distribution Profile)                                                                                                                                                     |
| AVRCP (Audio Video Remote Control Profile)                                                                                                                                                     |
| HFP (Hands-free Profile)                                                                                                                                                                       |
| HSP (Headset Profile)                                                                                                                                                                          |
| Codec: <sup>3)</sup> SBC <sup>®</sup> , AAC <sup>®</sup>                                                                                                                                       |
| <b>支援的內容保護法:</b> SCMS-T                                                                                                                                                                        |
| <b>傳輸範圍 (A2DP):</b> <ul style="list-style-type: none"><li>20 Hz - 20000 Hz（採樣頻率44.1 kHz）</li></ul>                                                                                             |
| <b>隨附物品:</b> <ul style="list-style-type: none"><li>無線立體聲耳機（1）</li> <li>Micro-USB連接線（約50 cm）（1）</li> <li>混合矽膠耳塞（SS/S/M/L各2個）</li> <li>參考指南（本頁）（1）</li> <li>使用說明書（1）</li> <li>其他文件（1套）</li></ul> |

- 實際範圍將會依裝置間的障礙物、微波爐周圍的磁場、靜電、接收敏感度、天線效能、操作系統、軟體應用程式等因素而有所不同。
- BLUETOOTH標準檔案說明裝置間BLUETOOTH通訊的目的。
- Codec：音壓壓縮和轉換格式子頻帶Codec
- 進階音訊編碼

### 無線立體聲耳機

|                                                                                                                                                                                                                                 |
|---------------------------------------------------------------------------------------------------------------------------------------------------------------------------------------------------------------------------------|
| <b>電源:</b>                                                                                                                                                                                                                      |
| DC 3.7 V: 內建鋰離子充電電池                                                                                                                                                                                                             |
| DC 5 V: 使用USB充電時                                                                                                                                                                                                                |
| <b>質量:</b> 約35 g                                                                                                                                                                                                                |
| <b>操作溫度:</b> 0 <span> </span> °C至40 <span> </span> °C                                                                                                                                                                           |
| <b>额定功耗:</b> 0.63 W                                                                                                                                                                                                             |
| <b>使用時間:</b> <ul style="list-style-type: none"><li>當從BLUETOOTH裝置連線使用時 <ul style="list-style-type: none"><li>音樂播放時間：最長20小時</li> <li>通訊時間：最長20小時</li> <li>待機時間：最長200小時</li></ul></li> <li>注意事項：使用時數可能會較短。視Codec和使用情況而定。</li></ul> |
| <b>充電時間:</b> <ul style="list-style-type: none"><li>約4.5小時（充電15分鐘後可播放音樂約60分鐘。）</li> <li>注意事項：充電時數可能視使用情況而有所不同。</li></ul>                                                                                                         |
| <b>充電溫度:</b> 5 <span> </span> °C至35 <span> </span> °C                                                                                                                                                                           |

|                              |
|------------------------------|
| <b>接收器</b>                   |
| <b>型式:</b> 封閉式，動態            |
| <b>激勵單元:</b> 9 mm            |
| <b>頻率響應:</b> 8 Hz - 22000 Hz |

**麥克風**

|                                                                                |
|--------------------------------------------------------------------------------|
| <b>型式:</b> 駐極體電容式                                                              |
| <b>指向性:</b> 全指向                                                                |
| <b>有效頻率範圍:</b> <ul style="list-style-type: none"><li>50 Hz - 8000 Hz</li></ul> |

### 使用USB為電池充電的系統要求

（截止至2017年8月）

預先安裝以下作業系統和USB埠的個人電腦：

|                                                                                                                                                                                        |
|----------------------------------------------------------------------------------------------------------------------------------------------------------------------------------------|
| <b>作業系統</b> （使用Windows時） Windows® 10 Home / Windows® 10 Pro Windows® 8.1 / Windows® 8.1 Pro Windows® 8 / Windows® 8 Pro Windows® 7 Home Basic / Home Premium / Professional / Ultimate |
| （使用Mac時） Mac OS X (10.9或更新的版本)                                                                                                                                                         |
| 設計和規格若有變更，恕不另行通知。                                                                                                                                                                      |

### 한국어

상호명: 소니코리아㈜

기자재명칭: 특정소출력 무선기기 (무선데이터통신시스템용 무선기기)

모델명: WI-C400

제조사 / 제조국가: Sony Corporation / Vietnam

제조연월: 커버에 표시

식별부호: MSIP-CRI-SOK-WI-C400

해당 무선설비는 전파혼신 가능성이 있으므로 인명안전과 관련된 서비스를 할 수 없습니다

책장이나 불박이 캐비닛과 같은 제한된 공간에는 본 장치를 설치하지 마십시오.

배터리(배터리 팩 또는 설치된 배터리)를 헛빛, 불 등과 같은 과도한 열에 장시간 노출시키지 마십시오.

다 쓴 배터리는 함부로 버리지 마십시오. 배터리를 폐기할 경우 소각 및 불속에 버리지 마십시오. 열로 인해 폭발 및 화재가 발생할 수 있습니다.

배터리는 잠깐 스레기 등과 같이 버리지 않아 주십시오. 재활용으로 분리배출 하십시오. 2차 단전자 전지를 폐기할 때는 서로 다른 전기 화학 시스템을 가진 단전자 전지를 서로 격리해 주십시오.

방사으로 인한 전자의 발열을 방지하기 위하여 방사상태로 폐기하여 주십시오.

단자 부분의 소트(단락)하지 않도록 테이퍼 등으로 싸서 버리 주십시오.

화장품이나 화장품 충전병을 따라서 충전하십시오.

장기간 보관 후에는 회로의 성능을 얻기 위해 단전자 또는 전지의 엔테나나 기기에 내장된 엔테나 사이에 장애물이 있으면 노이즈가 발생할거나 오디오가 소실되거나 통신이 작동되지 않을 수 있습니다.

다음 조건에서는 BLUETOOTH 통신이 작동되지 않거나 노이즈가 발생할거나 오디오가 소실될 수 있습니다.

CE 마크의

